

- Key**
- Existing
    - R.O.W. --- Right of Way
    - Property Line
    - Lot Line
  - Proposed
    - R.O.W. --- Right of Way
    - Property Line
- Profile**
- Ex. Grade ---
  - Prop. Grade ---

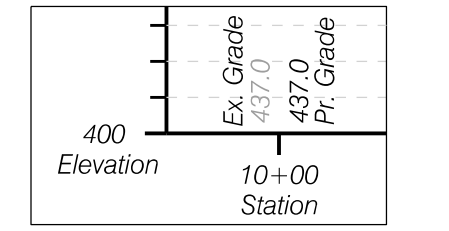

- Alignment Terminology**
- General  
 Sta: Station [10+24]  
 Elev: Elevation  
 POB: Point Of Beginning  
 EOP: Edge Of Pavement  
 EOTL: Edge Of Travel Lane  
 PGL: Profile Grade Line  
 HI: High Point  
 LO: Low Point
- Vertical Curves  
 PVC: Point Of Vertical Curvature  
 PVI: Point Of Vertical Intersection  
 PVT: Point Of Vertical Tangency  
 L: Length Of Curve  
 K: "Flatness" (Rate Of Curvature)  
 E: External Distance
- Horizontal Curves  
 PC: Point Of Curvature  
 PRC: Point Of Reverse Curvature  
 PCC: Point Of Compound Curvature  
 PI: Point Of Intersection  
 PT: Point Of Tangency  
 R: Radius  
 L: Length  
 I: Interior Angle  
 T: Tangent Length  
 E: External Distance

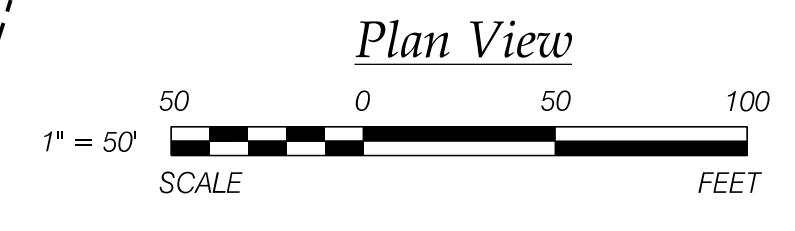
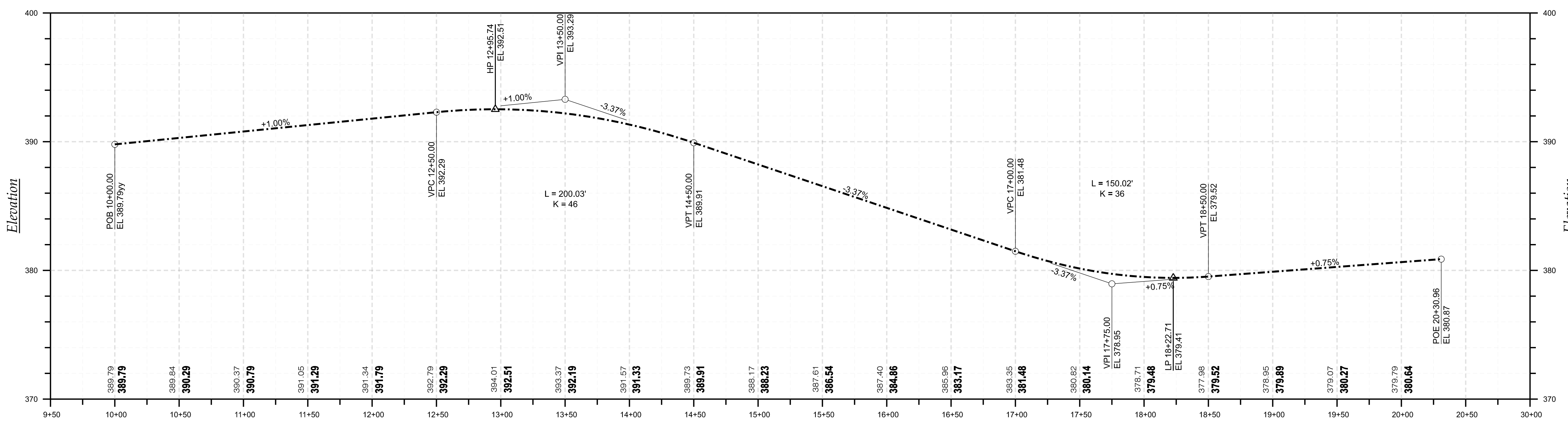

**Street A Profile**  
 Scale: Hor: 1" = 50'  
 Ver: 1" = 5'

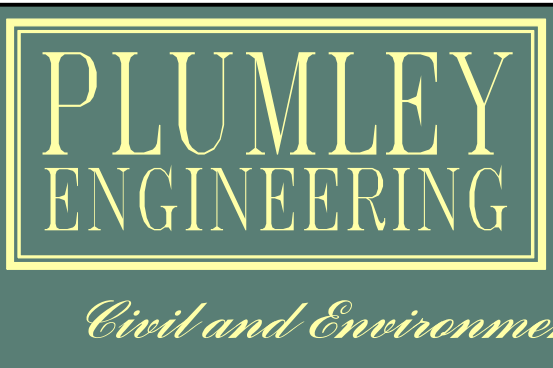

PLUMLEY ENGINEERING, P.C.  
 8232 LOOP ROAD  
 BALDWINVILLE, NY 13027  
 TELEPHONE: (315) 638-8587  
 FAX: (315) 638-9740  
 WWW.PLUMLEYENG.COM

REVISIONS:	DATE:	BY:

PROJECT: **VILLAS @ SENECA**  
 CLIENT: Ashley Real Estate Holdings, LLC  
 LOCATION: VILLAGE OF BALDWINVILLE, ONONDAGA COUNTY, NEW YORK

DWG. TITLE: **ROAD PLAN & PROFILE**

PROJECT No.: 2021077  
 FILE NAME: C401  
 SCALE: 1" = 50'  
 DATE: March 2025  
 ENGD BY: JFC  
 DRAWN BY: WCM  
 CHECKED BY: JFC

Note: No alteration permitted herein except as provided under Section 7209 Subdivision 2 of the New York State Education Law.